

SafeMask Architect Pro™

SURGICAL N95 RESPIRATOR FACE MASK

This medical grade respirator has been evaluated for use in healthcare settings according to recognized standards for biocompatibility, flammability and fluid resistance. It provides optimal respiratory protection by filtering 95% of particulate aerosols free of oil.

High-quality materials and duckbill shape offer optimal breathability — no exhalation valve required. Unique single-split comfort bands hold the mask in place without pulling or irritating skin. Lightweight construction ensures comfort, and an adjustable nose piece creates a personalised fit.

FEATURES & BENEFITS

- Reliable respiratory protection that filters out 95% of particulate aerosols free of oil.
- High-quality materials and duck-bill shape.
- Lightweight, breathable construction.
- Unique single-split comfort band.
- Adjustable nose piece.

ADJUSTABLE NOSE PIECE

UNIQUE SINGLE-SPLIT
COMFORT BANDS

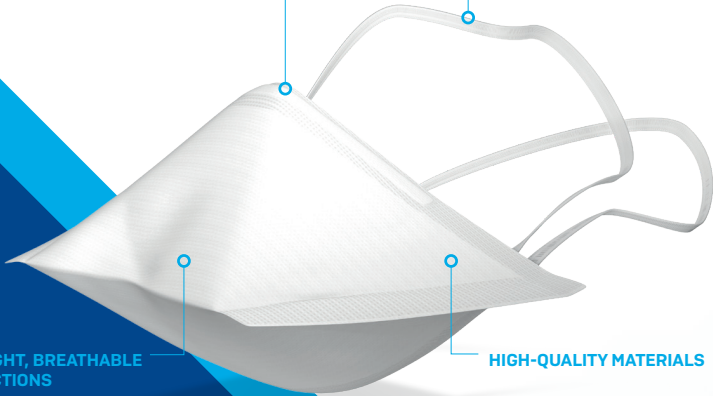

LIGHTWEIGHT, BREATHABLE
CONSTRUCTIONS

HIGH-QUALITY MATERIALS

SafeMask Architect Pro™

DONNING

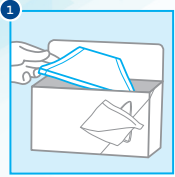

REMOVE MASK FROM PACKAGING

Remove mask from outer box

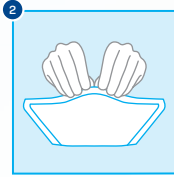

ARCH NOSE PIECE

Prepare by shaping the nose piece

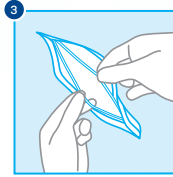

SEPARATE COMFORT BANDS

Hold the centre of the comfort bands and pull apart to separate

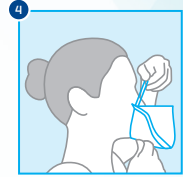

PUT THE MASK ON

Place the bottom of the mask under your chin

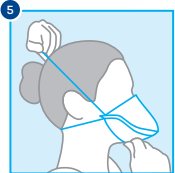

PUT ON THE COMFORT BANDS

Support the mask below your chin with one hand. With the other hand, pull comfort bands over your head

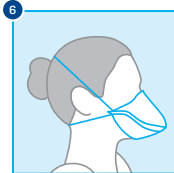

POSITION THE COMFORT BANDS

Place the top band around the crown of your head and position the bottom band so that it fits securely and comfortably

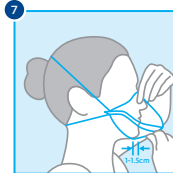

POSITION THE MASK CORRECTLY

Make sure the mask sits comfortably below your chin, about 1–1.5 cm behind the jawbone, and across the bridge of your nose

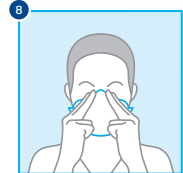

SEAL THE MASK

With two fingers on either side of your nose, firmly shape around your nose and across your cheeks, concentrating on the bridge of your nose, to secure the seal

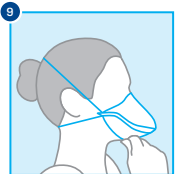

CHECK FIT

No air should leak from the edges of the mask. If in doubt, repeat step 8, pressing firmly



MAKE SURE THE MASK ADHERES TIGHTLY TO YOUR FACE

- A. Cup your hands over entire front of mask to block airflow.
- B. Inhale deeply.
- C. If any air flows around your nose, repeat step 8.

- D. If any air flows around the mask, carefully adjust the bands and repeat step 8.
- E. If fit is not satisfactory, do not enter an area where a mask is required.

DOFFING

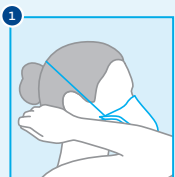

HOLD THE BANDS AT THE BACK OF YOUR HEAD

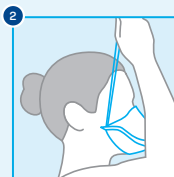

PULL THE BANDS OVER YOUR HEAD

Remove the mask by pulling it away from your face, taking care not to touch its outer surface

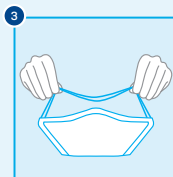

DISPOSE OF MASK

Still holding only bands, dispose of the mask in the clinical waste bin provided. Do not touch the fabric of the mask



WASH YOUR HANDS

Always wash your hands thoroughly after removing a mask

PROTECTION, BREATHABILITY & COMFORT YOU CAN RELY ON.



Manufactured By

AMD Medicom Inc.
2555 Chemin de l'Aviation, Montreal
Quebec, Canada H9P 2Z2
www.medicom.com

TGA - ARTG No. 380210

Distributed By

Majac Medical Products Pty Ltd
Ph: +617 3265 6355
Fax: +617 3865 2729
sales@majacmedical.com.au
www.majacmedical.com.au