

# TIDIShield® ASSEMBLE 'N GO™ EYE SHIELDS



TIDIShield Assemble 'n Go Eye Shields are designed to help reduce the risk of eye-splash incidents by providing a barrier to blood and body fluid splashes.

Aide in reducing cross-contamination between patient cases with single-use, disposable eyewear, proven to increase compliance of wearing eyewear by 5 times.



## Ideal for use in:

- Operating rooms
- Emergency rooms
- Labour & delivery departments
- Oncology/ Infusion centres
- Burn units

## Why do we need to throw away the disposable eyewear?

Many times even unnoticed spatter may occur during particular patient encounters. This spatter often contains contaminated body fluids, such as blood, mucous, saliva, and possibly even urine or fecal matter. The eyewear provides a significant shield to protect the eyes of the wearer from that contaminated spatter.

## Product Codes & Quantity

### Lenses:

- M9210-50 - 2x25 per pack
- M9210-100- 4 x 25perpack
- M9210-250 - 10x 25 per pack

### Frames:

- M9211-10- 10 per pack
- M9211-100 - 100 per pack
- M9211-400 - 4 x 100per pack

### Office Pack:

- MEOP - 10 frames and 25 lenses

## Are there any clinical studies to support that?

Yes. A recent study from Victor R. Lange found that 95% of reused eyewear showed microbial contamination and that nearly 3/4 of the eyewear still tested positive even after going through standard disinfection procedures. You can download his study, [The Role of Eyewear in Infection Prevention: The Reality of Eyewear Contamination Levels](#), to find out more.

## Features

- Extremely lightweight and comfortable - weighs only 9,5 grams!
- "Wraparound" design provides both front and side eye protection
- Available in two separate components (lens and frame)
- Optical grade, fog-resistant anti-static replacement shields available in clear, UV-tinted and amber-tinted (blue-light absorbent)
- Reusable frames available in mixed colors
- Latex-free
- Fits comfortably with a surgical mask and over prescription eyewear
- Patented design
- Separately available replacement frames and lenses for maximized cost-effective replenishment
- Meets the requirements for both [OSHA](#) and [EEC](#) mandates



3 steps to assemble:



# TIDIShield® ASSEMBLE 'N GO™ FACE SHIELDS



Healthcare professionals work under hazardous and ever-changing conditions; what they need is superior face protection from the splash and splatter of blood-borne pathogens and other potentially infectious materials.

TIDIShield Assemble 'n Go Face Shields are a cost-effective face protection product. Face shields are lightweight, cool and offer comfortable protection that can be worn over prescription eye wear, face masks and loupes.

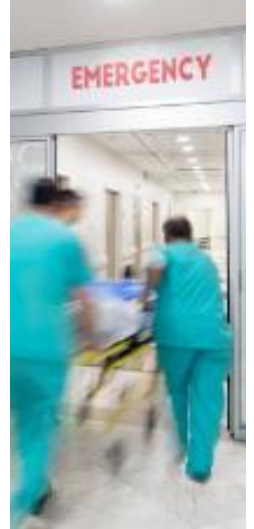

## Features

Weighs less than 42gm  
Designed to maximize airflow and prevent fogging.  
Provides over-the-top, side and front face protection.  
Disposable, optical grade, anti-static replacement shields.  
Includes a clear, snap-in nose piece for support.

Improved Visual Clarity	Proprietary venting system
	Anti-fog film enhances visual activity
	Optical-grade face shield
Lasting Comfort	Adjustable head strap secures face shield while in use; comfortable to wear for long periods of time
Confident, Secure Protection	Proprietary splash guard
	Larger face shield - 12" x 9.5" and 12" x 7.5" sizes for maximum protection
	Not made from natural latex rubber

## The Need for Protective Face Wear

Infectious diseases can be transmitted through various mechanisms, among which are infections that can be introduced through the mucus membrane of the eye (conjunctiva).

Infectious agents (viruses & bacteria) can be introduced directly to the eye (ie. Blood splashes, respiratory droplets generated during coughing or suctioning) or from touching the eyes with contaminated fingers or objects. The World Health Organisation (WHO) and the Center for Disease Control and Prevention (CDC) states that prescription glasses or contact lenses are not considered eye protection.

*CDC – Centers for Disease Control and Prevention, Eye Protection for Infection Control, 2013, July 29*

## ASSEMBLY INSTRUCTIONS

For ultimate under face protection, place visor on the bottom hole, for more room, place visor on the top shield hole.

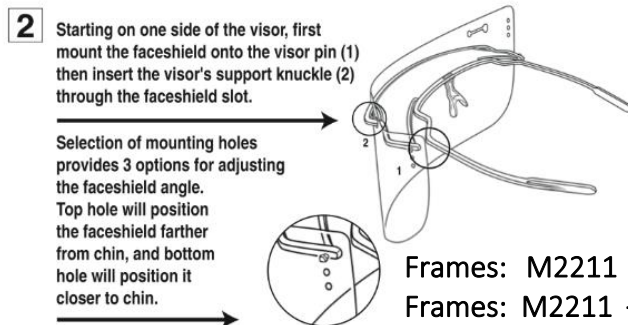
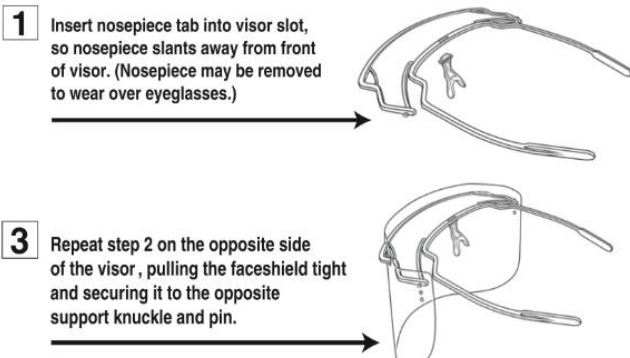

Product Codes & Qty

Frames: M2211 – 10 (10 per pkt)  
Frames: M2211 – 100 (100 per ctn)  
Lenses: M2210 – 100 (100 per box)

Also available from: